

**Ohio Department of Transportation  
Office of Traffic Engineering  
April 18, 2008**

**To Holders of the OTE Plan Insert Sheets (PISs):**

**As of April 18, 2008 one new OTE Plan Insert Sheets (PISs) has been issued.**

The updated publications and the separate PIS revision package are available from the links below, the ODOT Design Reference Resource Center (<http://www.dot.state.oh.us/drrc/>), or from the Office of Traffic Engineering's Home Page (<http://www.dot.state.oh.us/traffic/>), using the Publications/Documents link.

**Per ODOT policy, paper copies of the publications are no longer distributed to all holders. Revisions will only be available via the web pages noted above.**

For questions, comments, or concerns please contact either:

Juanita Elliott, P.E., Traffic Standards Engineer or Lisa McConnell, Traffic Standards Technician  
(614-644-8143 or [Juanita.Elliott@dot.state.oh.us](mailto:Juanita.Elliott@dot.state.oh.us)) (614-728-9361 or [Lisa.McConnell@dot.state.oh.us](mailto:Lisa.McConnell@dot.state.oh.us))

OTE PIS sheets	What's New Page	Traffic Home Page
April 18, 2008 Revision Package for the PISs		



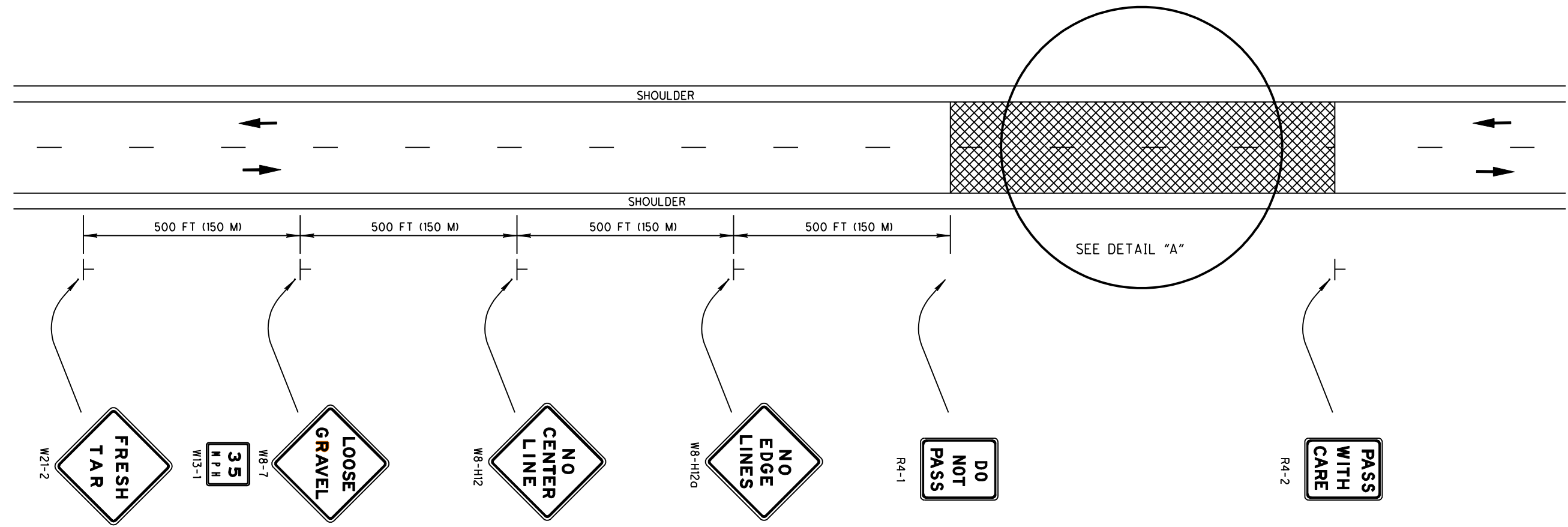

**GENERAL NOTES:**

1. The suggested minimum sign spacing is 200 feet (60 m), with 500 feet (150 m) spacing desirable.
2. The NO CENTER LINE (W8-H12), NO EDGE LINE (W8-H12a), and DO NOT PASS (R4-1) signs should be repeated every 2 miles per CMS 614.04.
3. Repeat the LOOSE GRAVEL (W8-7) with an Advisory Speed Plaque (W13-1) every 1/2 mile per CMS 422.09.
4. Remove the NO CENTER LINE (W8-H12) and NO EDGE LINES (W8-H12a) signs after placing final markings.
5. Repeat sign layout in opposite direction.
6. Temporary traffic control for chip seal operations is not shown.
7. For signing of side roads intersecting the work area, see Detail "A".

**LEGEND**

